

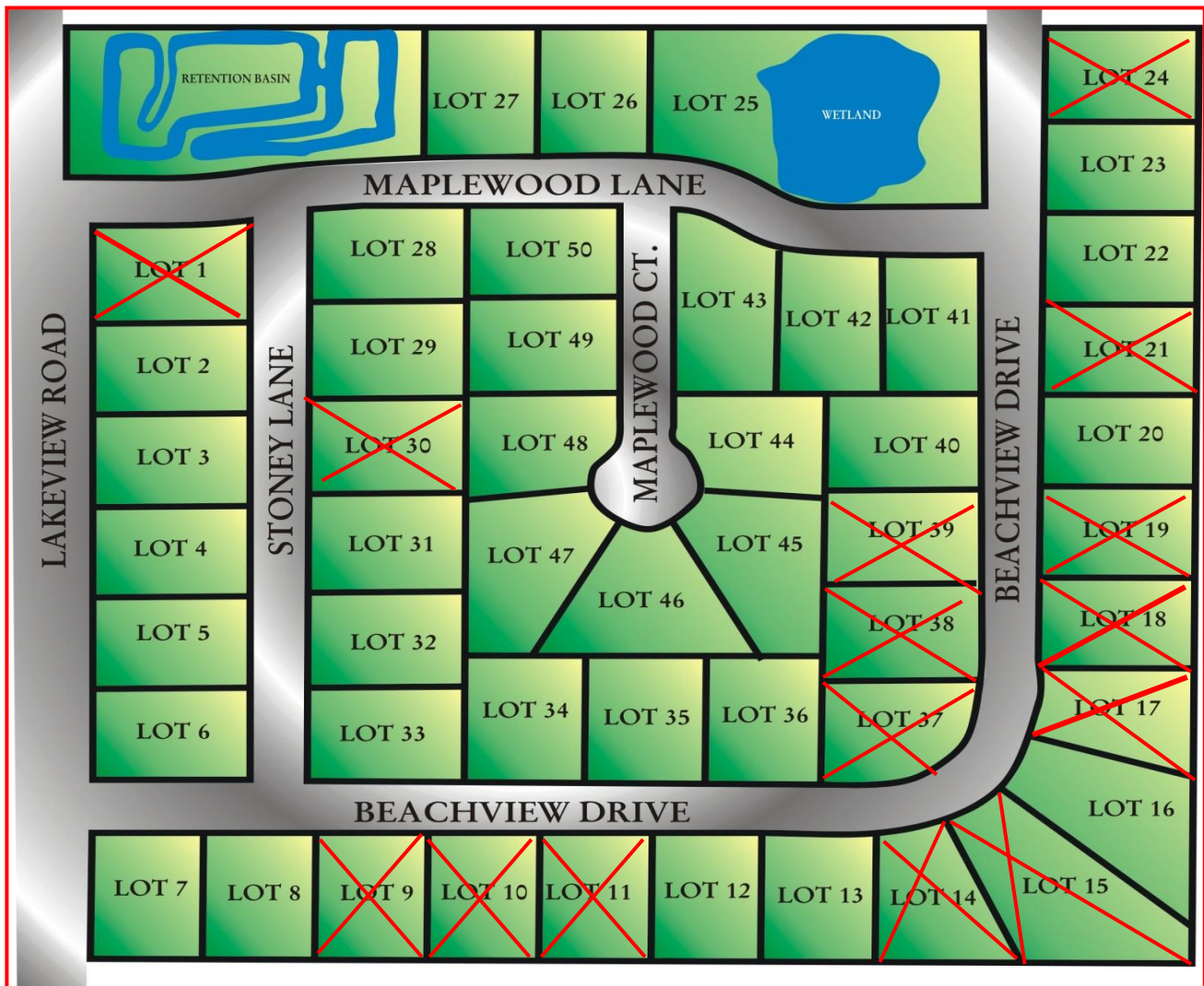

# LAKEVIEW

## ESTATES



- Open To All Builders
- City Sewer
- Private or Shared Wells

Offered By:

**Roberts**  
**Homes**  
And Real Estate

**Directions:** Highway 151 Bypass north to Silica Road, right to Lakeview Road, right to Subdivision

1315 S Main Street, Fond du Lac, WI

**920-923-4522**

**Sewer Assesment Connection Fees- : \$5,383**

*Note: Retaining walls may be required depending on the site and the plan for lookout and walkout basements.*

